

# Retain Maximum Performance.



The Edstrom A160 drinking valve is a precision engineered instrument made from high quality stainless steel and silicone components. Its consistent performance is critical for your animals.

As the drinking valves are repeatedly sanitized, sterilized and handled over time, the performance of the silicone parts within the valve may begin to degrade. The rate at which this happens is variable depending on the SOPs maintained by each lab.

With varying conditions of these internal parts you are leaving their proper function up to chance and risking harm to your animals.

Our E-vive<sup>SM</sup> valve care program provides a scheduled, proactive approach that systematically renews the drinking valves to their original factory specifications. By joining the E-vive<sup>SM</sup> program, you retain maximum performance of your system and help laboratory operations run smoothly.

At Edstrom, we are committed to supporting you by keeping your system operating at peak performance.



## What does the E-vive<sup>SM</sup> program offer?

- ✓ Retain maximum performance of A160 drinking valves
- ✓ Proactive approach to valve renewal that reduces the risk to the animals
- ✓ Two year warranty
- ✓ Peace of mind

## E-vive<sup>SM</sup> Proactive Plans

**BEST**

### Preventative Maintenance

- Multi year commitment to restore valves on a scheduled interval shipment basis.
- Minimum 250 valves per shipment.
- Minimum (2) shipments per year
- More comprehensive protection.
- Locked in lowest cost per valve per length of contract.
- Easiest annual planning.

**BETTER**

### Monthly/Quarterly

- One (1) year commitment to restore valves on a scheduled interval shipment bases.
- Minimum 250 valves per shipment.
- Minimum (2) shipments over the year.
- Lowest Cost per valve.

**GOOD**

### Individual Orders

- Ideal for facilities that do not want a one (1) year or commitment.
- Recommended minimum 250 valves per order.



**Our professional staff is dedicated to you, your animals, and research.**

**A160 Valve Component Performance**

The frequency of autoclaving, chemical exposure, and handling of the valves impact the performance of silicone. Weakened silicone parts may lead to higher water flow to the animal with excess water falling to the bedding.

**VALVE PERFORMANCE** Based on bi-weekly autoclaving - Flow of 25-60 mL/minute (Edstrom specification flow rate) with fully actuated valve.

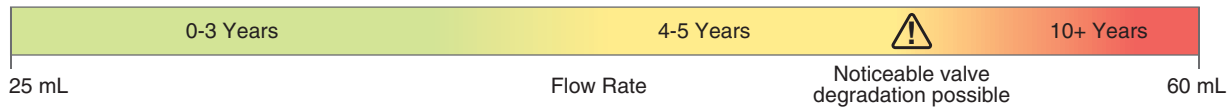

**A160 Valve Restoration Process**

The E-vive<sup>SM</sup> process brings together restored A160 components with all new silicone parts and a new stainless steel stem.

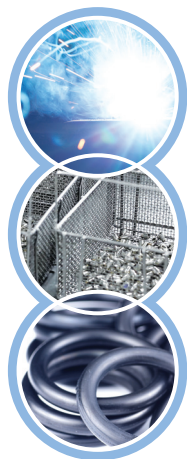
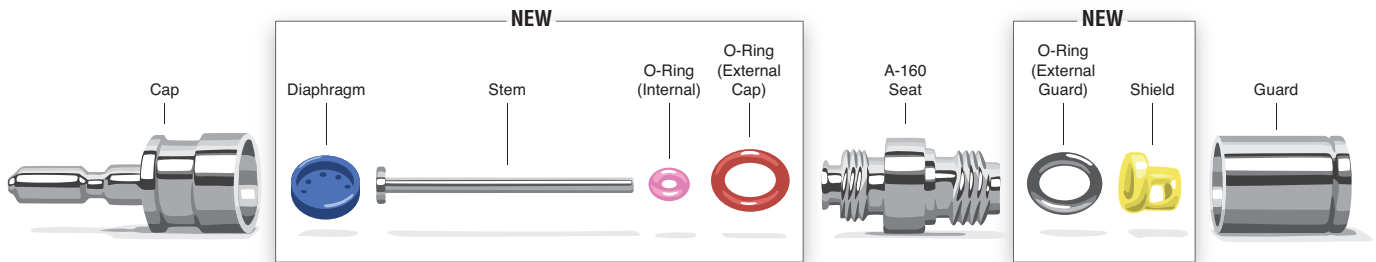

**THERMAL FINISHING**

The thermal finishing process involves exposing parts to high heat which incinerates any lingering debris.

**RE-PASSIVATED**

The stainless steel parts are passivated by submerging them into an acid bath protecting them from corrosion.

**NEW SILICONE COMPONENTS**

The valve is then reassembled with new silicone components along with a new stem, and stainless steel refurbished parts.



**INDUSTRIALLY CLEAN**

Valve components are reassembled by our skilled valve assembly team under clean, dust and lint free conditions.

**TESTING & ETCHING**

Each valve is 100% tested and the refurbishment date is laser etched on the part before leaving our facility.

**2-YEAR WARRANTY**

Warrantied for two years from the date of refurbishment.



**Thank you for relying on Edstrom automated watering to deliver water to your valuable mice and rats.**

Being proactive with the care of your valves will aid in continued high performance. Contact Edstrom today to discuss which E-vive<sup>SM</sup> program is best for you.

Edstrom Industries, LLC  
819 Bakke Avenue Waterford, WI 53185 USA  
Tel: 262-534-5181 or 800-558-5913  
www.edstrom.com

ISO 9001:2015 Certified

